

Visual Level Indicators (VLI) Plastic & Top of Tank Series

Series	Type	Material	Pipe O.D. x s (mm)	Operating Pressure	Operating Temperature	Page
Plastic thread 10	25670	PVDF	63.0 x 3.6	2.5-10 thread	max. 140°C	61
Plastic thread 2.5	25672	PP	"	"	max. 80°C	61
"	25674	PVC	"	"	max. 60°C	61
Plastic Flange 10	25475	PVDF	63.0 x 3.0	2.5-10 Flange	max. 140°C	62
Plastic Flange 2.5	25478	PP	"	"	max. 80°C	62
"	25479	PVC	"	"	max. 60°C	62
Plastic Flange 10	25470	PVDF	"	2.5-10 Flange	max. 140°C	63
Plastic Flange 2.5	25480	PP	"	"	max. 80°C	63
"	25490	PVC	"	"	max. 60°C	63
Plastic 20	32706	PTFE/PFA	n.a.	max. 20 bar@ 20°C	max. 200°C	64
Top of Tank 10	25271	PVDF	63.0 x 3.0	2.5-10	max. 140°C	65
Top of Tank 2.5	25272	PP	63.0 x 3.6	"	max. 80°C	65
"	25274	PVC	63.0 x 3.0	"	max. 60°C	65
Top of Tank 16	23013	316/316L	53.0 x 1.5	max 6 bar@ 20°C	max. 400.°C	66
"	25270	316/316L	"	"	"	67
Accessories						68

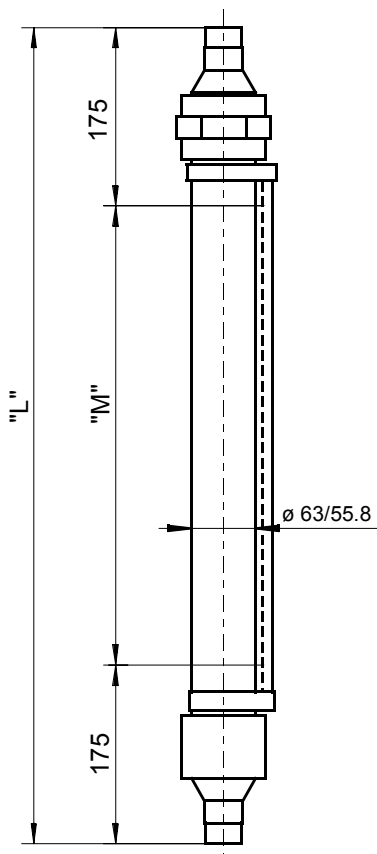

Technical Data

Operating Conditions

Medium

Density

min 0.75 g/cm³

g/cm ³

Pressure/Temperature

Op. Pressure Type 25670

max. 10 bar g

	bar g
--	-------

Type 25672

max. 2,5 bar g

	bar g
--	-------

Type 25674

max. 2,5 bar g

	bar g
--	-------

Design Pressure

	bar g
--	-------

Op. Temp. Type 25670

max. 140 °C

	° C
--	-----

Type 25672

max. 80 °C

	° C
--	-----

Type 25674

max. 60 °C

	° C
--	-----

Design Temperature

	° C
--	-----

Indication Rail

Version

Makrolon

Makr.with protection tube

Alu red flaps

Material

Float chamber

PVDF resp. PP resp. PVC

Float

PVDF resp. PP resp. PVC

Dimensions

Total length

Dimension " L "

 mm

Process Connections

Female thread

G 1/2"

Accessories

Magnetic Switch

number	Type
--------	------

Transmitter

Type	Indication length	mm
------	-------------------	----

Control unit/voltage

Volt	AC / DC	Type
------	---------	------

Additional Accessories acc. attached sheet

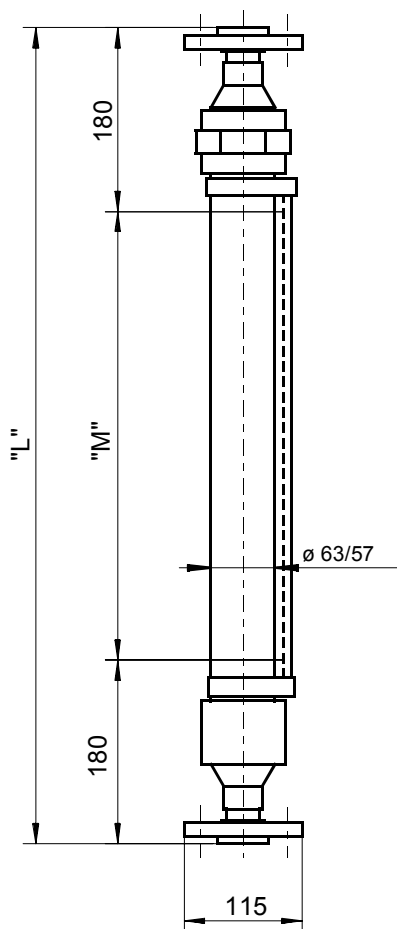

Technical Data

Operating Conditions

Medium

Density

min 0.75 g/cm³

	g/cm ³

Pressure/Temperature

Op. Pressure Type 25475 max. 10 bar g
 Type 25478 max. 2,5 bar g
 Type 25479 max. 2,5 bar g

Design Pressure

Op. Temp. Type 25475 max. 140 °C
 Type 25478 max. 80 °C
 Type 25479 max. 60 °C

Design Temperature

	bar g
	bar g
	bar g
	bar
	°C
	°C
	°C
	°C

Indication Rail

Version

Makrolon
 Makr. with protection tube
 Alu flaps red

Material

Float chamber PVDF resp. PP resp. PVC
 Float PVDF resp. PP resp. PVC

Dimensions

Total length Dimension " L "

	mm
--	----

Flange Connections

Flange connection with saddle flange and bushing

Standard/Nom.Pressure VSM 18696/PN10
 DIN 8063/PN10

Nominal Diameter DN 25

DN

Accessories

Magnetic Switch
 Transmitter
 Control unit/voltage

Number	Type
Type	Indication length mm
Volt	AC / DC Type

Additional Accessories acc. attached sheet

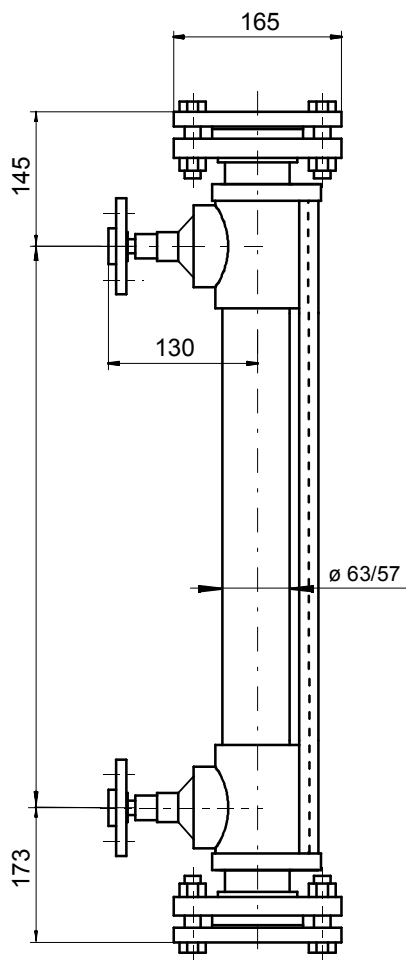

Technical Data

Operating Conditions

Medium

Density

min 0.75 g/cm³

	g/cm ³
--	-------------------

Pressure/Temperature

Op. Pressure Type 25470 max. 10 bar g
 Type 25480 max. 2,5 bar g
 Type 25490 max. 2,5 bar g

	bar g
	bar g
	bar g

Design Pressure

	bar g
--	-------

Op.Temp. Type 25470 max. 140 °C
 Type 25480 max. 80 °C
 Type 25490 max. 60 °C

	°C
	°C
	°C

Design Temperature

	°C
--	----

Indication Rail

Version

Makrolon
 Makr. with protection tube
 Alu flaps red

Material

Float chamber (wetted parts) PVDF resp. PP resp. PVC
 Float PVDF resp. PP resp. PVC

Dimensions

Connection distance Dimension " L "

	mm
--	----

Flange Connections

Flange connection with saddle flange and bushing
 Standard/Nom.Pressure VSM 18696/PN10
 DIN 8063/PN10
 Nom.Diameter (Standard) DN 15-32

Accessories

Magnetic Switch
 Transmitter
 Control unit/voltage

Number	Type	
Type	Indication length	mm
Volt	AC / DC	Type

Additional Accessories acc. attached sheet

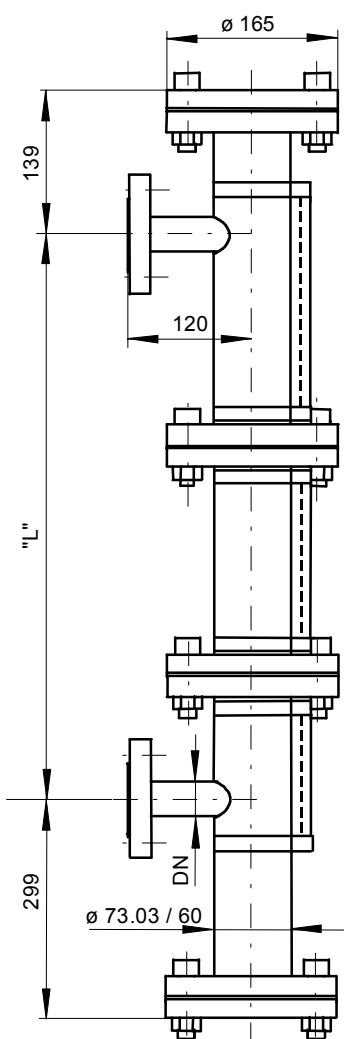
Technical Data
Operating Conditions
Medium
Density

 min 0.6 g/cm³
 g/cm³
Pressure/Temperature

Operating pressure

max. 20 bar g

 bar g

Design pressure

 bar g

Operating temperature

max. 200 °C

 °C

Design temperature

 °C

Indication Rail

Operating temperature

Version

max. 150 °C

Makrolon

max. 150 °C

Makr.with protection tube

max. 250 °C

Alu - flaps red

Material

float chamber

316 / 316L

Top- and bottom parts (T-pieces) with PFA-coating

Center parts with PTFE-lining

float

Glass (Borosilicate)

Hastelloy C-276

Titan

Dimensions

Connection distance

Dimension " L "

 mm

Flange Connections

DN25 PN16

1" ANSI cl.150

2" ANSI cl.150

2" ANSI cl.300

Accessories

Magnetic switch

 number

 Type

Transmitter

 Type

 Indication length

 mm

Control Unit/Voltage

 Volt

 AC / DC

 Type

Additional Accessories acc. attached sheet

Type 25271 PVDF / 10
 Type 25272 PP / 2,5
 Type 25274 PVC / 2,5

Level Indicators

Data Sheet 14.01 -65-

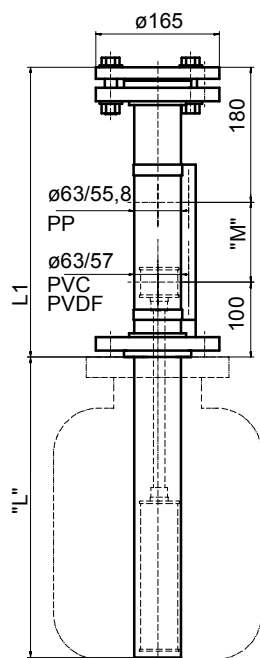

Technical Data

Operating Conditions

Medium

Density

depending on length of instrument (see table below)

	g/cm ³

Pressure/Temperature

Operating pressure Type 25271 max. 10 bar g
 Type 25272 max. 2,5 bar g
 Type 25274 max. 2,5 bar g

	bar g
	bar g
	bar g
	bar g
	°C
	°C
	°C
	°C

Design pressure

Operating temp. Type 25271 max. 140 °C
 Type 25272 max. 80 °C
 Type 25274 max. 60 °C

Design temperature

Indication Rail

Version

Makrolon
 Makr. with protection tube
 Alu flaps red

<input type="checkbox"/>
<input type="checkbox"/>
<input type="checkbox"/>

Material

float chamber
 float

PVDF resp. PP resp. PVC
 PVDF resp. PP resp. PVC

Dimensions

Dimension L M + min. 200 mm
 Dimension L1 M + 280 mm
 Length of extension tube L - 130 mm

	mm
	mm
	mm

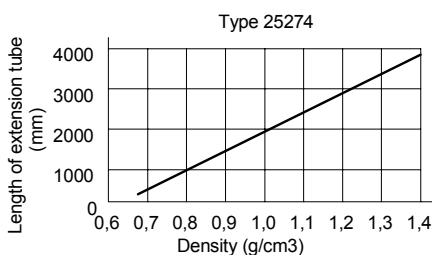
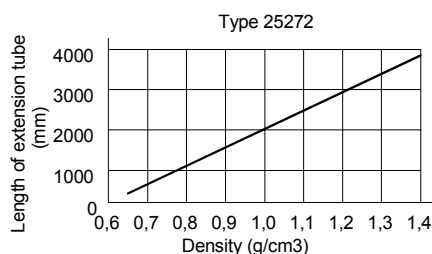
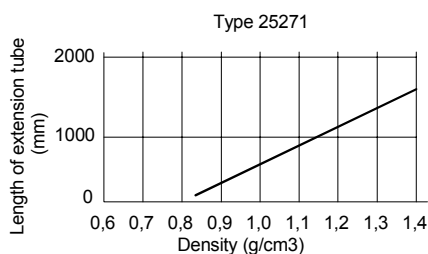

Connection Flanges

Connecting flange: Saddle flange and bushing
 VSM 18696 / PN10
 DIN 8063 / PN10

<input type="checkbox"/>
<input type="checkbox"/>

Nom. Diameter (Standard) DN 50

DN

Accessories

Magnetic switch
 Transmitter
 Control Unit/voltage

number	Type
Type	Indication length mm
Volt	AC / DC Type

Additional Accessories acc. attached sheet

<input type="checkbox"/>

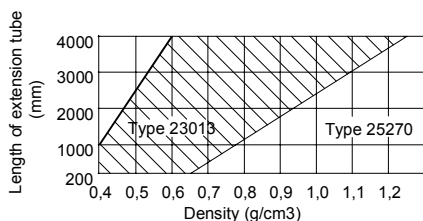
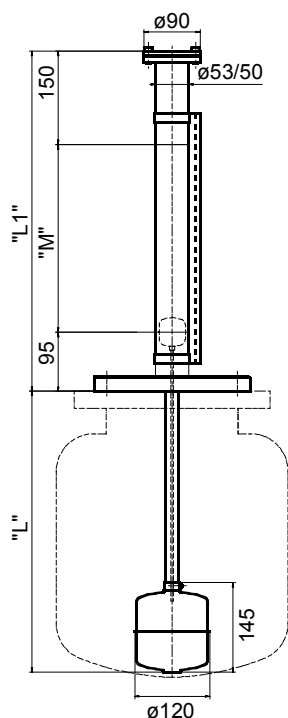

Technical Data

Operating Conditions

Medium

Density

depends on length of instrument (see table below)

	g/cm ³

Pressure/Temperature

Operating pressure

max. 6 bar g

	bar g
--	-------

Design pressure

	bar g
--	-------

Operating temperature

max. 400 °C

	° C
--	-----

Design temperature

	° C
--	-----

Indication Rail

Operating temperature

Version

max. 150 °C

Makrolon

max. 250 °C

Alu red flaps

max. 400 °C

Alu black flaps

Material

float chamber

316 / 316L

float

316L

Dimensions

Dimension L

M + min. 152 mm

	mm
--	----

Dimension L1

M + 245 mm

	mm
--	----

Length of extension tube

L - 46 mm

	mm
--	----

Flange Connections

VSM 18697 / PN16

DIN 2576 / PN10

BS 4504 / 16 / 3

ANSI B16.5 / cl150

Nom. Diameter (Standard)

DN 125

	DN
--	----

Flange facing

flat face

--

Accessories

Magnetic switch

number

	Type
--	------

Transmitter

Type

	Indication length	mm
--	-------------------	----

Control Unit/voltage

Volt

AC / DC

	Type
--	------

Material Certificate

EN 10 204-3.1B

Nondestructive Testing (possibilities)

Dye penetrant testing

Additional Accessories acc. attached sheet

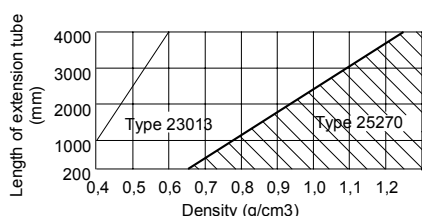
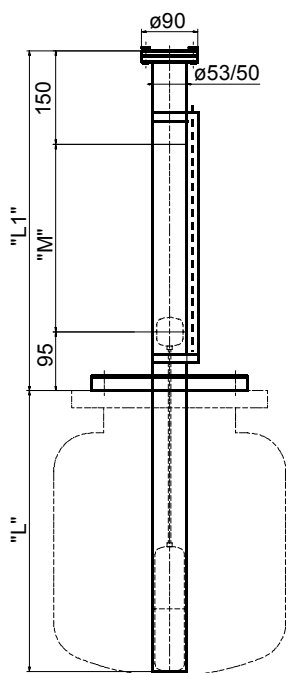
Technical Data
Operating Conditions
Medium
Density

depending on length of instrument (see table below)

	g/cm ³

Pressure/Temperature

Operating pressure

max. 6 bar g

Design pressure

bar g

Operating temperature

max. 400 °C

bar g

Design temperature

°C

°C

Indication Rail

Operating temperature

Version

max. 150 °C

Makrolon

max. 250 °C

Alu red flaps

max. 400 °C

Alu black flaps

<input type="checkbox"/>
<input type="checkbox"/>
<input type="checkbox"/>

Material

float chamber

316 / 316L

float

316L

Dimensions

Dimension L

M + min. 200 mm

mm

Dimension L1

M + 245 mm

mm

Length of extension tube

L - 140 mm

mm

Flange Connections

VSM 18697 / PN16

DIN 2576 / PN10

BS 4504 / 16 / 3

ANSI B16.5 / cl150

Nominal Diameter

DN 50

DN

Flange facing

flat face

--

Accessories

Magnetic switch

number

Type

Transmitter

Type

Indication length

mm

Control Unit/voltage

Volt

AC / DC

Type

Material Certificate

EN 10 204-3.1B

Nondestructive Testing (possibilities)

Dye penetrant testing